

LINLEY RIDGE NEIGHBOURHOOD | 3D Massing Model

Rezoning Application - December 2023

Appendix

3D MASSING MODEL

3D MASSING MODEL

SNAPSHOTS KEY PLAN

Location of the snapshots shown in the following pages:

- 1 Intersection Uplands Dr + Rutherford Rd
- 2 Southwest property corner + Rutherford Rd
- 3 South Parcel Main entrance (Rutherford Rd)
- 4 Intersection Rutherford Rd + Linley Valley Dr
- 5 North Parcel Main entrance (Linley Valley Dr)
- 6 Bird's-eye View - Southwest corner
- 7 Bird's-eye View - Southeast corner
- 8 Bird's-eye View - Northeast corner
- 9 Bird's-eye View - From the North
- 10 Bird's-eye View - Northwest corner



1 Intersection Uplands Dr + Rutherford Rd

Looking north towards the property

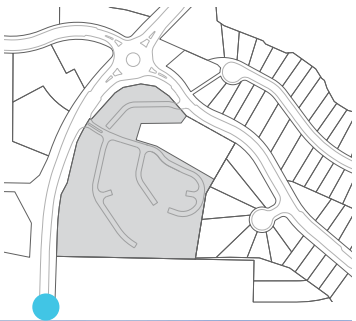

2 Southwest property + Rutherford Rd

Looking north Rutherford Rd.

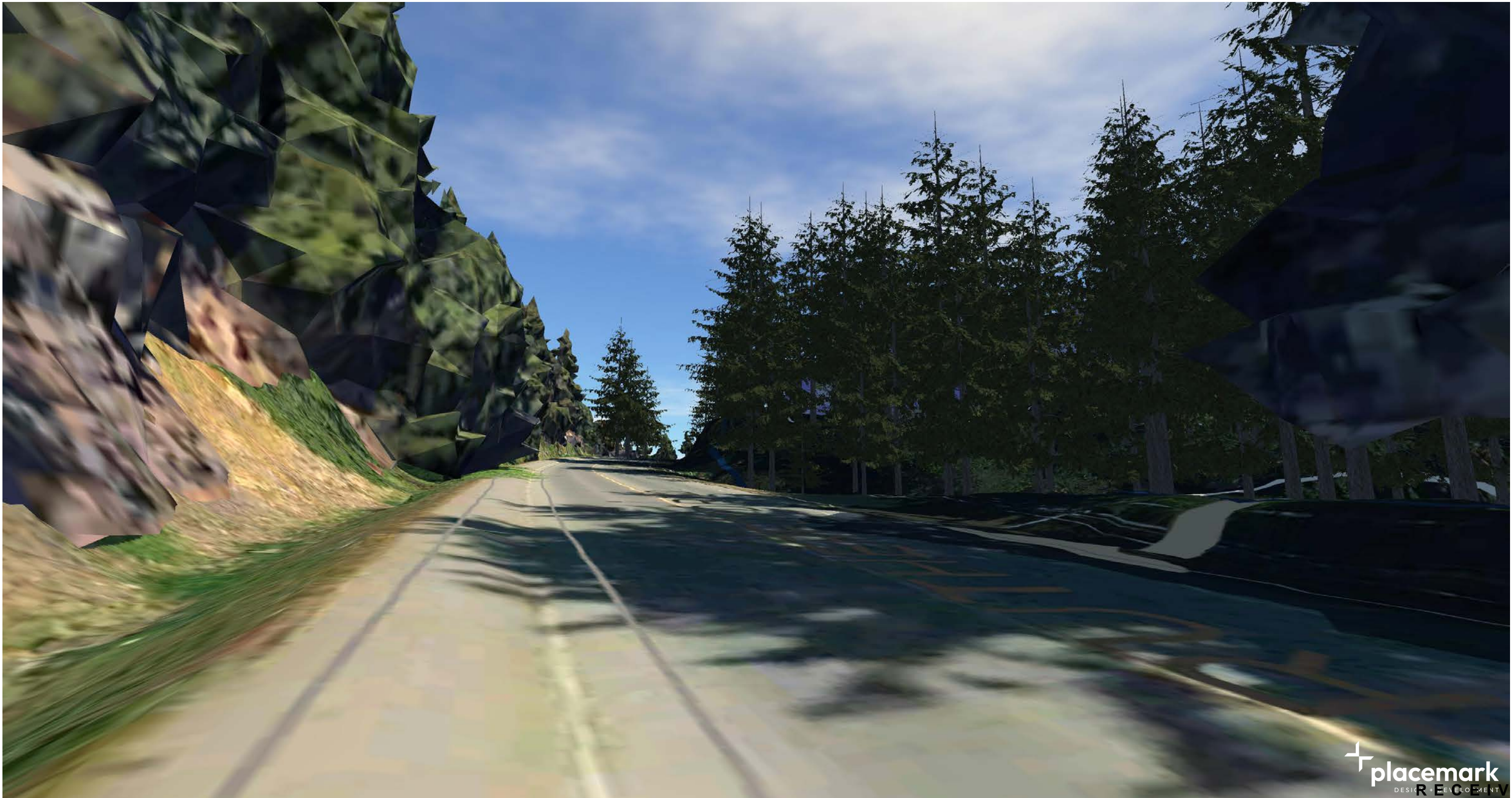
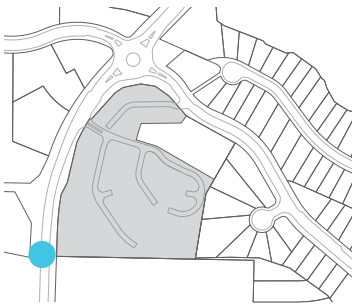

3 South Parcel Main Entrance - Rutherford Rd

From the intersection on the other side of Rutherford Rd, looking towards the Main Entrance to the project's South Parcel.

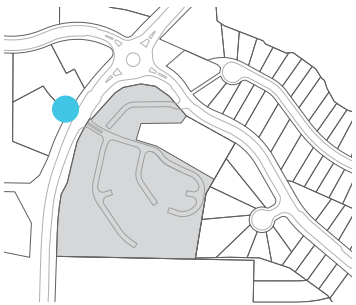

4 Intersection Linley Valley Dr + Rutherford Rd

From the roundabout on the intersection of Linley Valley Dr and Rutherford Rd, looking towards the northwest corner of the site.

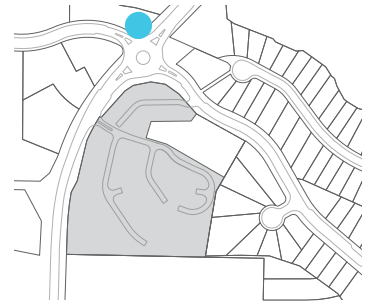

placemark
RECEIVED

RA502

2024-JAN-15

Current Planning

5 North Parcel Main Entrance - Linley Valley Dr

From Linley Valley Dr, looking towards the Main Entrance to the project's North Parcel.

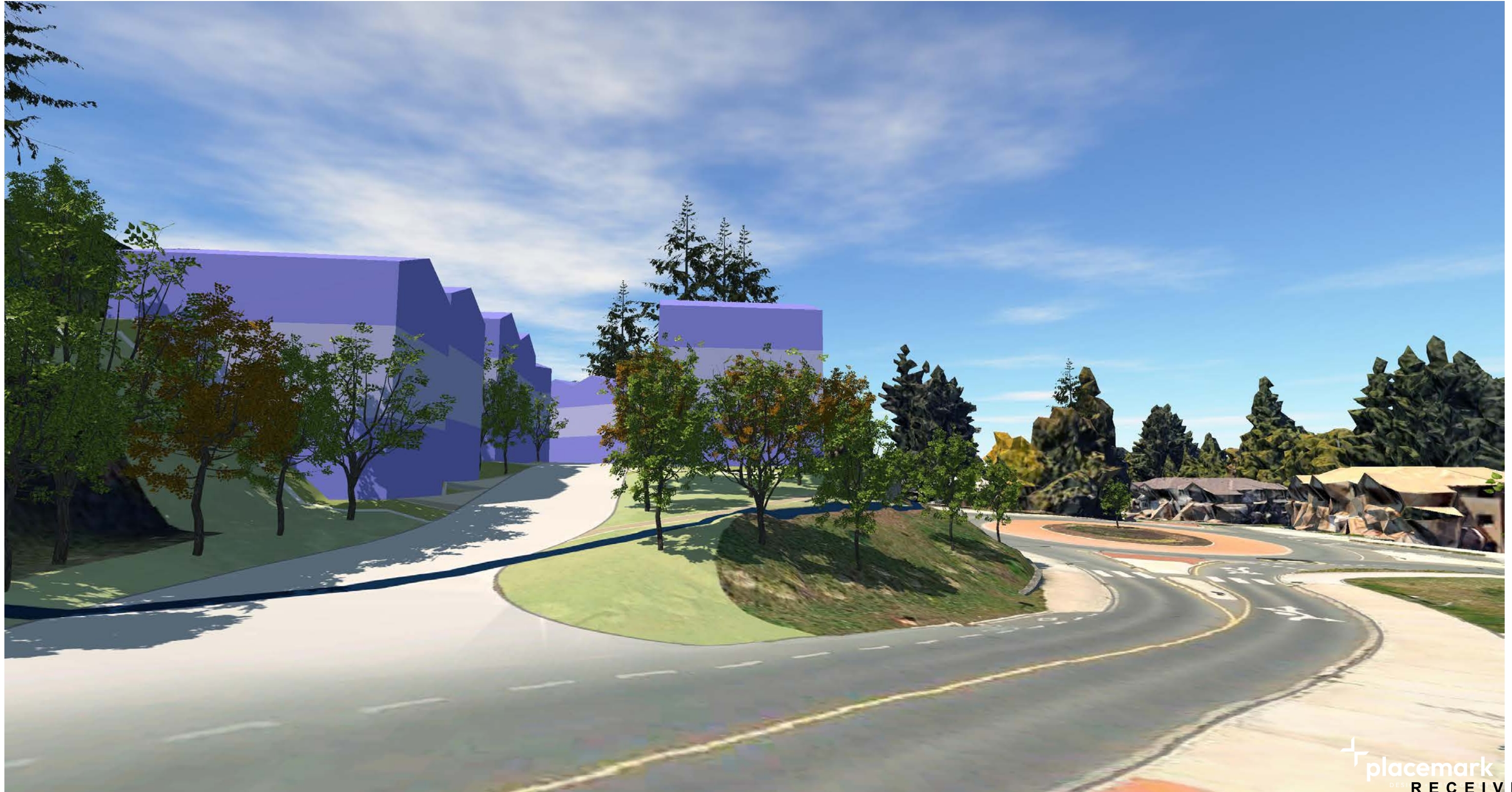
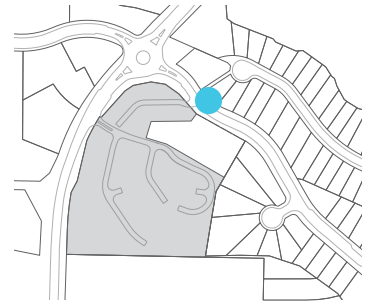

6 Bird's-eye View - Southwest corner

From the southwest, looking towards the north.

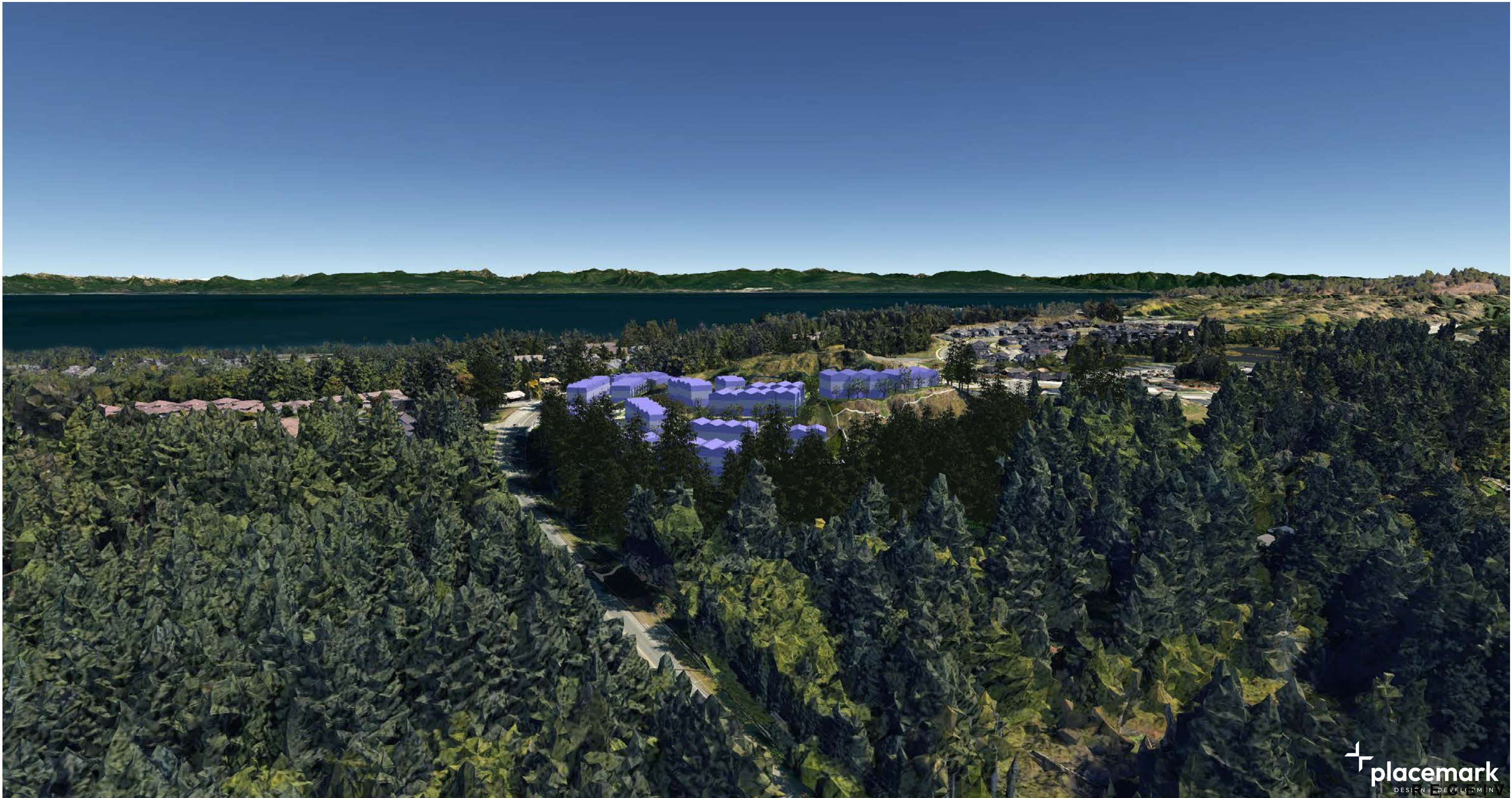
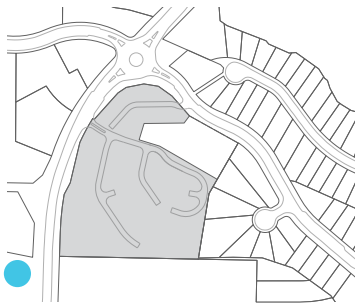

7 Bird's-eye View - Southeast corner

Looking towards the northeast.

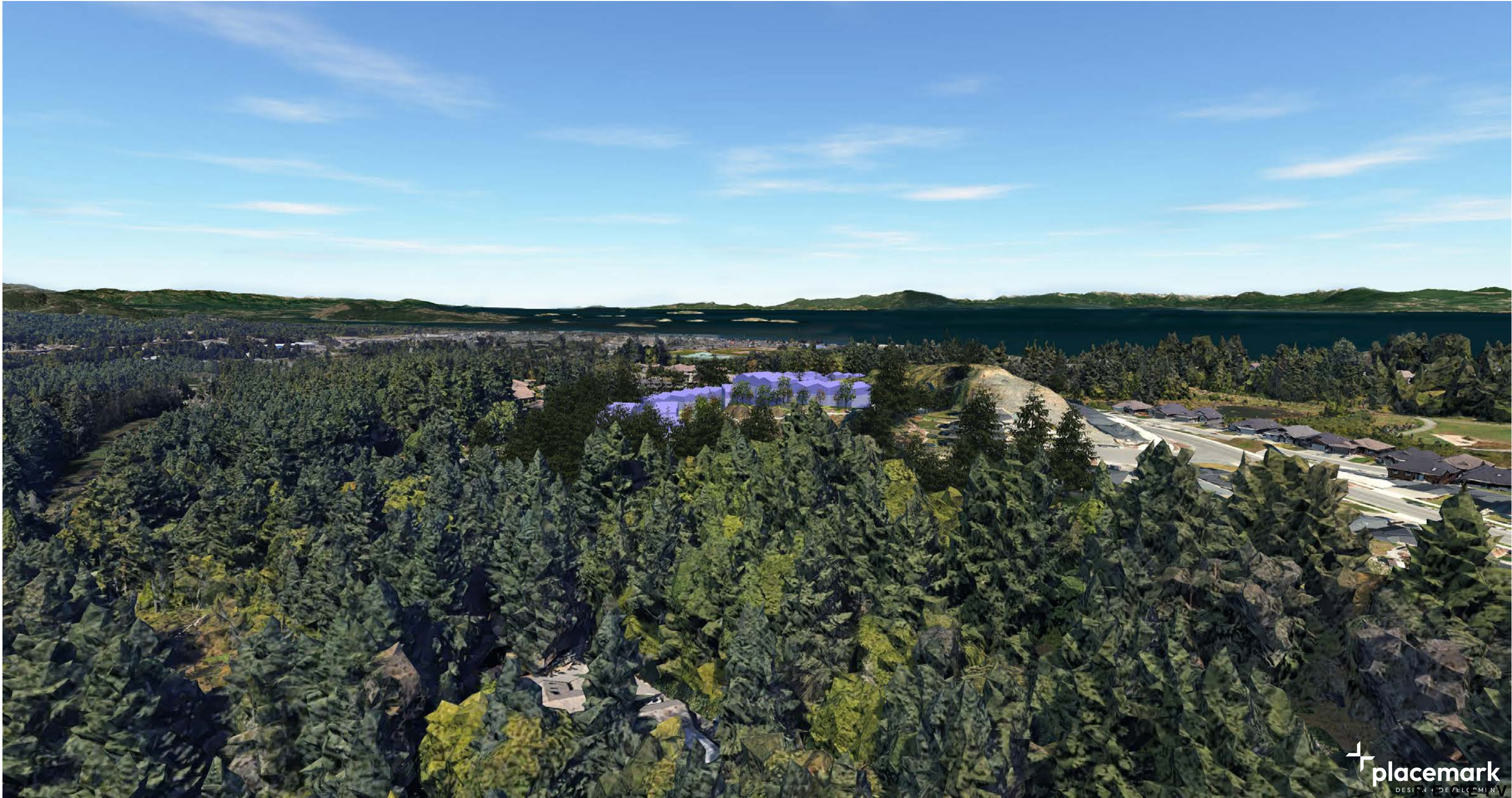
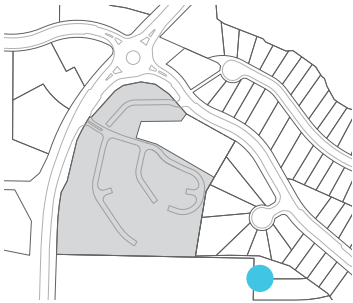

8

Bird's-eye View - Northeast corner

Looking towards west.

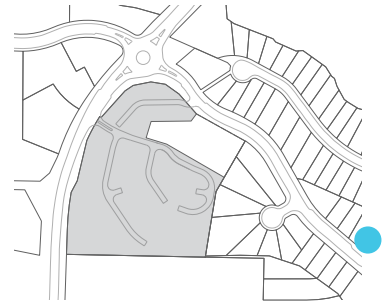

9 Bird's-eye View - From the North

Looking towards the south.

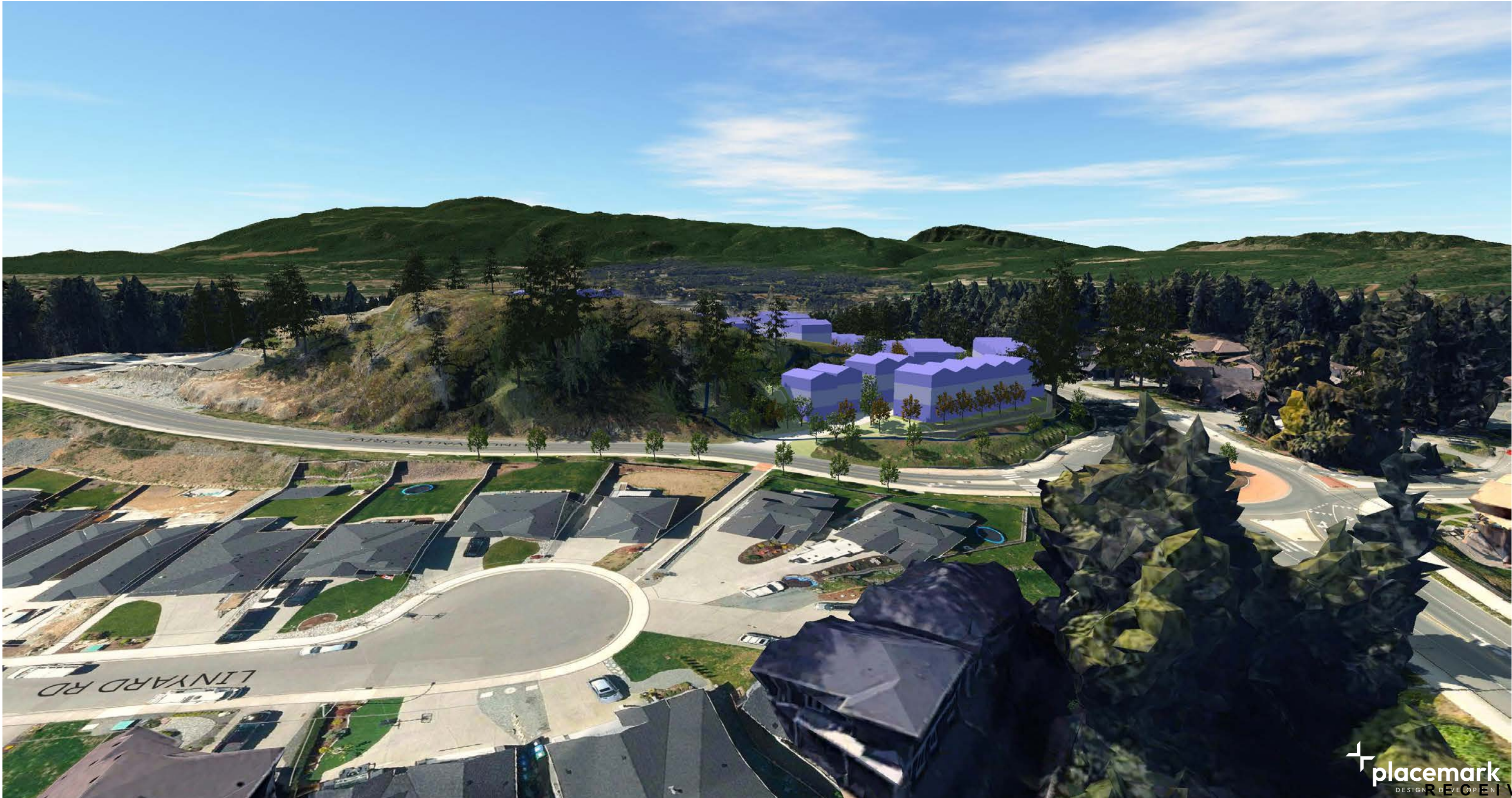
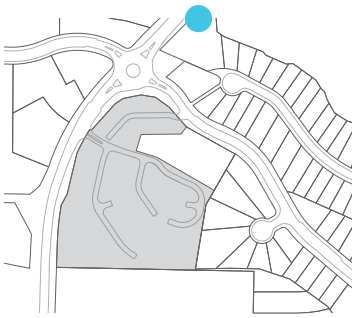

10 Bird's-eye View - Northwest corner

Looking towards the southeast.

